



Setting up AppLock with GSS Mobile shortcut

Written By: Eric Sutter



Step 1 — Activate AppLock

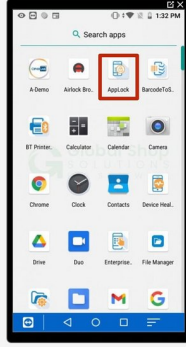

- Open the mobile device
- From the Home screen, swipe up to reveal the app list.
- Tap the icon for AppLock at the top (it looks like a smartphone with a padlock).
- Tap "Allow" to let it use AppLock as the home app.

Step 2 — Enter Admin Mode

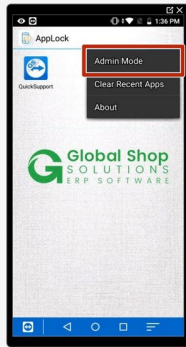
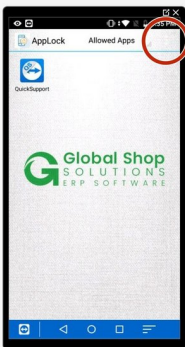

- AppLock should now be enabled; the AppLock name and icon should show at the top of the screen, and if you swipe up the app list shouldn't appear.
- Tap the 3 dots at the top right of the screen to see the list of options.
- Tap "Admin Mode."
- Tap "Login"; by default there is no password.

Step 3 — Open App Management

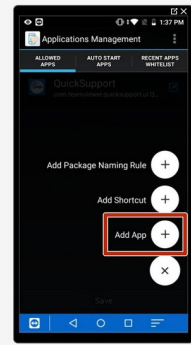
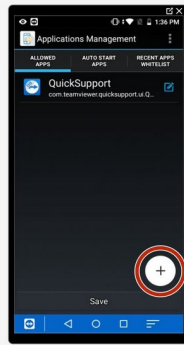
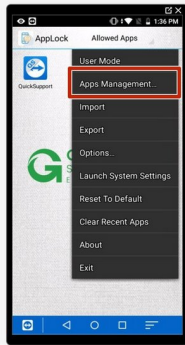

- Tap the 3 dots at the top again - there should be a lot more options now.
- Tap "App Management."
- Tap on the + symbol at the bottom right, then tap on "Add App."

Step 4 — Add Chrome

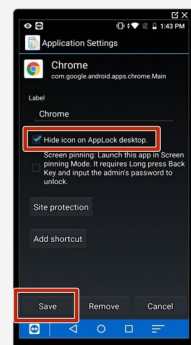
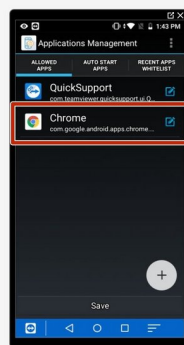

- Check the box for the Chrome app, then tap "Save" at the bottom.
- Tap on Chrome in the "Allowed Apps" list.
- Tap "Hide Icon" then tap "Save" at the bottom.

Step 5 — Add GS Mobile shortcut

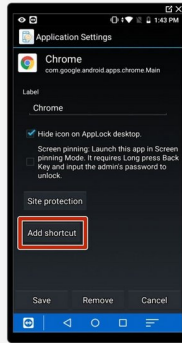
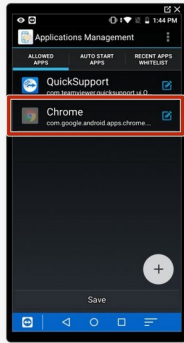

- Tap on Chrome - it should now be slightly greyed-out.
- Tap "Add Shortcut."
- For "Label", put "GS Mobile."
- For "URL", put "<https://gsmobile.emsbarcode.com/>"
- Select the option for "WebApp style" Launch mode.
- Tap "Add" at the bottom.

Step 6 — Checking the shortcut

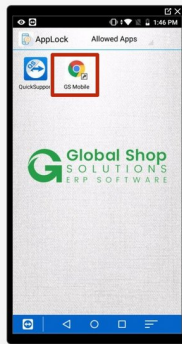
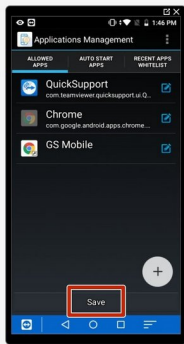

- Hit "Save" - You should now just see a google Chrome shortcut labeled "GS Mobile."
- Tap on the shortcut to make sure it works. It should look like the example screenshot, and you should be able to open the Company Code dropdown.

Step 7 — Exit Admin Mode

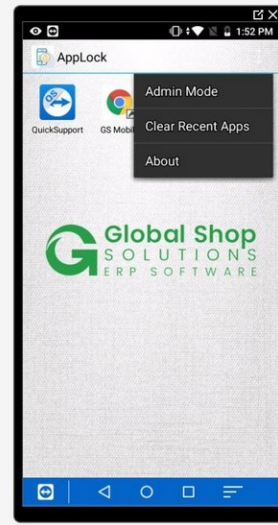

- Hit the Home button to exit the web app.
- Tap the 3 dots at the top right.
- Select "User Mode."
- User mode should now be enabled; if you tap the 3 dots you should only see a few options.

Step 8 — How to Exit/Disable AppLock

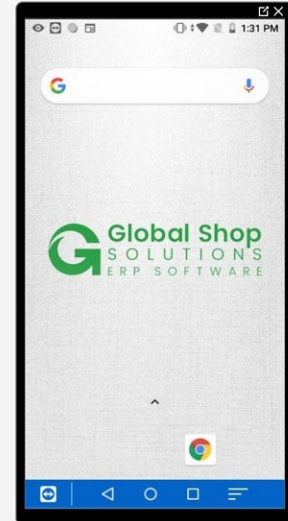

- Enter Admin mode, as described in Step 2.
- Tap the 3 dots at the top right of the screen.
- Tap "Exit" at the bottom of the list.
- AppLock should now be disabled; the regular home screen should now show, and you should be able to swipe up to show the full app list.